



888-696-8695

TROUT STREAM

Asking

\$68,900.

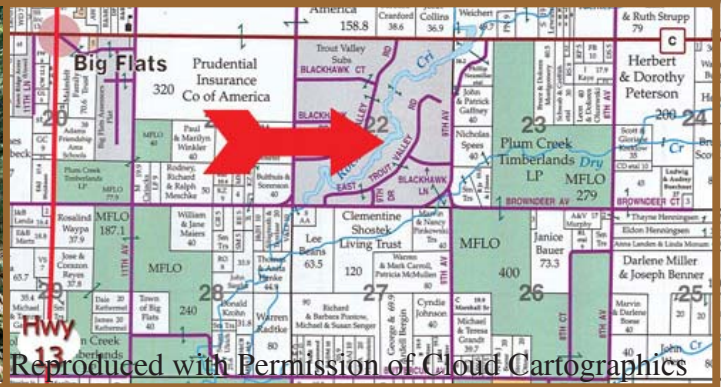
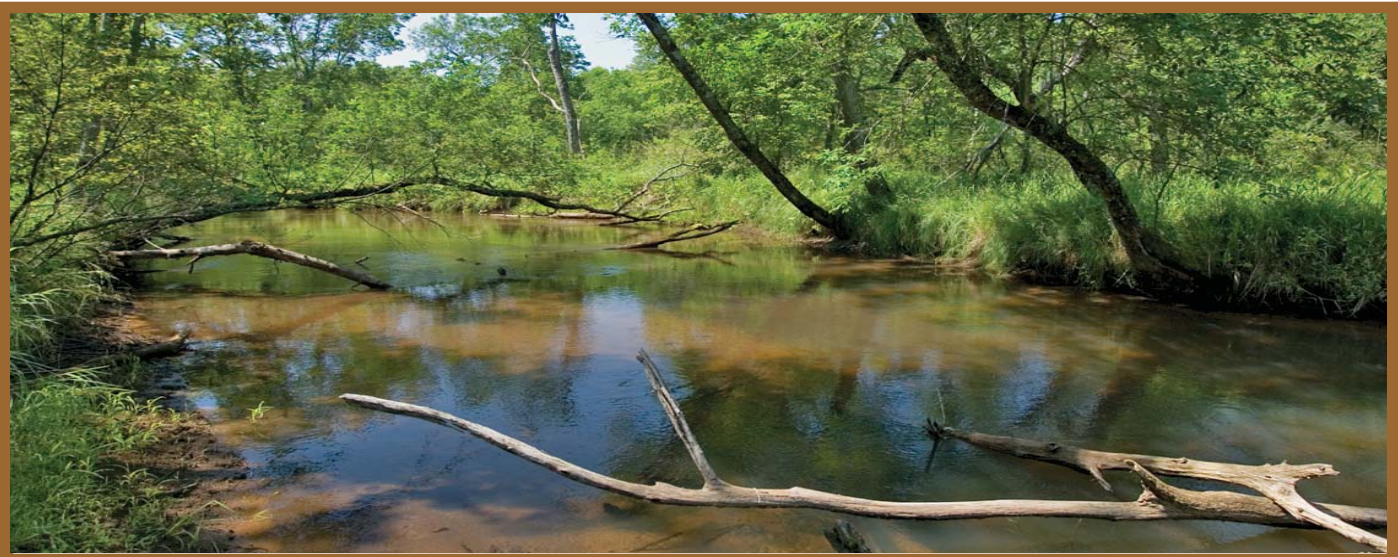

5 Acres with Building Site Already Clear

| | |
|---------------------------|---|
| Description | Wooded Waterfront Lot |
| Property Size | 5 +/- Acres |
| Taxes 2004 | \$323. |
| Electric | By Property |
| Phone | By Property |
| Property Features: | Waterfront, Wooded Area, Big White Pine, Building Site already cleared, |
| Area Amenities: | Lake Petenwell, Castle Rock Lake, Tri-Lakes, Golf, Public Land & More. |

Almost 5 acres on an excellent trout fishing stream with lots of wildlife, deer and turkey. Don't miss out on this great building site with trees cleared for a house, pole barn, or garage and driveway - the building possibilities for this lot are numerous. This lots has many big oaks and white pines to make this setting an ideal buildable site. It is a must see to appreciate the property. From Adams-Friendship: Take Hwy 13 North to Browndeer and go East to Trout Valley Rd and turn left (North) to 932 E. Trout Valley Rd.

www.TheLandman.net